



COLARUS GROUP

+1-877-359-1257 (Toll Free)

+1-238-938-1727

+1-905-594-1727

# Coupling Reducing

**Malleable Black Iron**

Black Malleable Iron Reducer Coupling with two female-threaded connections. This fitting allows the user to connect (or couple) two different-sized pipelines. It is ideal for extending a pipe to reach another section of the system with a different-sized pipe. Installation is very simple, as it does not require any welding or soldering. An inexpensive thread sealant will be required for a water tight seal. Black iron is resistant to pressure, heat, and corrosion, so it is most often found in gas and oil systems.

**Standard:**

EN10242 / ANSI / ASME B16.3 / DIN2950 / ISO49 / NBR6943 / Is1879 / EN10242

**Thread Standard:**

EN10226 / ASME B1.20.1 / DIN 2999 ISO-1 / ISO228 / IS 554 / BS EN10226

**Working Pressure**

PN 25 / 2.5 MPA / CLASS 150 / 25 BAR

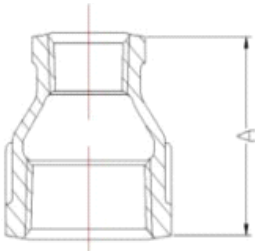

Product Code	Product Description	Size	DN	A	Weight (g)	PSI
		(ANSI)	(mm)	(mm)		
COUR-38-14-MBK	Coupling Reducer 3/8" x 1/4" MalleableBlack Iron	3/8" x 1/4"	10 x 8	29	42	150
COUR-12-14-MBK	Coupling Reducer 1/2" x 1/4" MalleableBlack Iron	1/2" x 1/4"	15 x 8	35	66	150
COUR-12-38-MBK	Coupling Reducer 1/2" x 3/8" MalleableBlack Iron	1/2" x 3/8"	15 x 10	36	69	150
COUR-34-14-MBK	Coupling Reducer 3/4" x 1/4" MalleableBlack Iron	3/4" x 1/4"	20 x 8	38	86	150
COUR-34-38-MBK	Coupling Reducer 3/4" x 3/8" MalleableBlack Iron	3/4" x 3/8"	20 x 10	38	91	150
COUR-34-12-MBK	Coupling Reducer 3/4" x 1/2" MalleableBlack Iron	3/4" x 1/2"	20 x 15	38	105	150
COUR-1-14-MBK	Coupling Reducer 1" x 1/4" MalleableBlack Iron	1" x 1/4"	25 x 8	44	132	150
COUR-1-38-MBK	Coupling Reducer 1" x 3/8" MalleableBlack Iron	1" x 3/8"	25 x 10	44	128	150
COUR-1-12-MBK	Coupling Reducer 1" x 1/2" MalleableBlack Iron	1" x 1/2"	25 x 15	44	142	150
COUR-1-34-MBK	Coupling Reducer 1" x 3/4" MalleableBlack Iron	1" x 3/4"	25 x 20	44	150	150
COUR-114-12-MBK	Coupling Reducer 1-1/4" x 1/2" MalleableBlack Iron	1-1/4" x 1/2"	32 x 15	49	203	150
COUR-114-34-MBK	Coupling Reducer 1-1/4" x 3/4" MalleableBlack Iron	1-1/4" x 3/4"	32 x 20	49	214	150
COUR-114-1-MBK	Coupling Reducer 1-1/4" x 1" MalleableBlack Iron	1-1/4" x 1"	32 x 25	49	225	150
COUR-112-12-MBK	Coupling Reducer 1-1/2" x 1/2" MalleableBlack Iron	1-1/2" x 1/2"	40 x 15	53	247	150
COUR-112-34-MBK	Coupling Reducer 1-1/2" x 3/4" MalleableBlack Iron	1-1/2" x 3/4"	40 x 20	53	254	150
COUR-112-1-MBK	Coupling Reducer 1-1/2" x 1" MalleableBlack Iron	1-1/2" x 1"	40 x 25	53	277	150
COUR-112-114-MBK	Coupling Reducer 1-1/2" x 1-1/4" MalleableBlack Iron	1-1/2" x 1-1/4"	40 x 32	53	312	150
COUR-2-12-MBK	Coupling Reducer 2" x 1/2" MalleableBlack Iron	2" x 1/2"	50 x 15	63	392	150
COUR-2-34-MBK	Coupling Reducer 2" x 3/4" MalleableBlack Iron	2" x 3/4"	50 x 20	63	406	150
COUR-2-1-MBK	Coupling Reducer 2" x 1" MalleableBlack Iron	2" x 1"	50 x 25	63	414	150
COUR-2-114-MBK	Coupling Reducer 2" x 1-1/4" MalleableBlack Iron	2" x 1-1/4"	50 x 32	63	435	150
COUR-2-112-MBK	Coupling Reducer 2" x 1-1/2" MalleableBlack Iron	2" x 1-1/2"	50 x 40	63	475	150

Working Pressure : 25BAR / 363PSI / MPA / CLASS / PN 25  
 Temperature : 200 °c (392°F)  
 Tensile Strength : ≥350MPA  
 Elongation : ≥10%  
 Hardness : ≤HB150



3588 Grassie Road, Grassie.  
 ON, Canada. L0R 1M0  
 E-mail: [sales@colarusgroup.ca](mailto:sales@colarusgroup.ca)  
 E-mail: [colarusgroup@gmail.com](mailto:colarusgroup@gmail.com)

